

PTV—PRESSURE / TEMPERATURE VENT

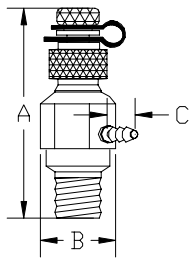

PATENT #6899317

Combination manual air vent and pressure/temperature test port with brass body, dual durometer EPDM core, blowout-proof stem, side discharge vent with 1/8" (4mm) hose barb, threaded brass cap with O-ring seal and neoprene retainer strap. Accepts standard 1/8" (4mm) gauge adapter or thermometer stem. Rated to 250 PSI (1725 kPa) and 250°F (120°C).

MODEL	NPT CONN	A		B		C		WRENCH SIZE	WEIGHT	
		in	mm	in	mm	in	mm		lbs	kg
PTV-025	1/4"	1.50	40	0.84	21	0.32	9	3/4"	0.154	0.07
PTV-050	1/2"	1.50	40	0.98	25	0.32	9	3/4"	0.225	0.10

PT—PRESSURE / TEMPERATURE PORT

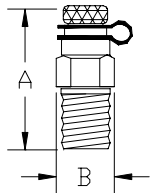

Pressure/Temperature test port with brass body, dual durometer EPDM core, brass cap with O-ring seal and neoprene retainer strap. Accepts standard 1/8" (4mm) gauge adapter or thermometer stem. Rated to 500 PSI (3450 kPa) and 275°F (135°C).

MODEL	NPT CONN	A		B		WRENCH SIZE	WEIGHT	
		in	mm	in	mm		lbs	kg
PT-025	1/4"	1.29	33	0.62	16	9/16"	0.06	0.03
PT-050	1/2"	1.29	33	1.00	25	7/8"	0.18	0.08

PTE—PTV/PT EXTENDER

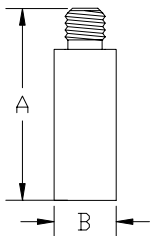

Extender for PTV and PT models, used on insulated piping systems or where extended length is desired. The PTE is installed above the PTV or PT core with an O-ring seal. The PTE can be installed in the field without removing the PTV or PT from the piping system. Brass body with EPDM O-ring seal. Rated to 500 PSI (3450 kPa) and 250°F (120°C).

MODEL	A		B		WEIGHT	
	in	mm	in	mm	lbs	kg
PTE	1.59	41	0.54	14	0.90	0.04

AE—ACCESSORY EXTENSION

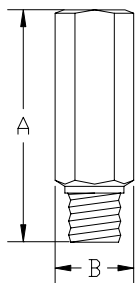

Accessory Extension installs below any accessory where extended length is required, such as insulated piping systems. Brass body, MNPTxFNPT. Rated to 500 PSI (3450 kPa) and 250°F (120°C).

MODEL	NPT CONN	A		B		C		WRENCH SIZE	WEIGHT	
		in	mm	in	mm	in	mm		lbs	kg
AE-025	1/4"	1.94	49	0.72	19	1.50	40	5/8"	0.11	0.05
AE-050	1/2"	2.19	55	1.16	29	1.50	40	1"	0.32	0.14

MAV—MANUAL AIR VENT

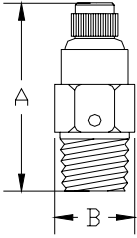

Manual air vent with brass body, knurled operator with screwdriver slot, blowout-proof stem, and side discharge vent. Rated to 400 PSI (2760 kPa) and 250°F (120°C).

MODEL	NPT CONN	A		B		WRENCH SIZE	WEIGHT	
		in	mm	in	mm		lbs	kg
MAV-025	1/4"	1.75	44	0.625	16	9/16"	0.80	0.04

AAV—AUTOMATIC AIR VENT

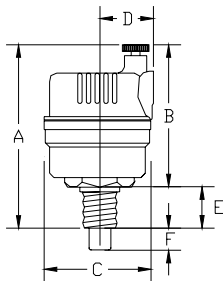

Automatic air vent with brass body, plastic float, brass seat, and EPDM seal. Rated to 150 PSI (1035 kPa) and 240°F (115°C).

MODEL	NPT CONN		A	B	C	D	E	F	WEIGHT	
									lbs	kg
AAV-025	1/4"	in	3.125	2.625	1.625	0.81	0.125	0.50	0.30	0.14
		mm	80	67	42	21	4	15		

DV—DRAIN VALVE

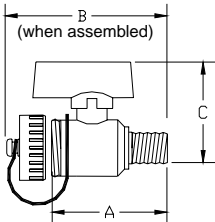

Drain valve with forged brass body, chrome plated ball, Teflon seats, double EPDM O-ring stem seals, aluminum handle, 3/4" hose connection with cap and plastic retainer strap. Rated to 600 PSI (4140 kPa) WOG and 250°F (120°C).

MODEL	NPT CONN	A		B		C		WEIGHT	
		in	mm	in	mm	in	mm	lbs	kg
DV-025	1/4"	1.88	48	2.10	53	1.35	34	0.30	0.13
DV-050	1/2"	2.40	61	2.73	69	1.54	39	0.44	0.20

MS—MEMORY STOP

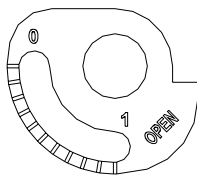

Memory stop, Zinc plated steel with position indicator

EH-EXTENDED HANDLE

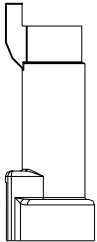

Handle Extension, forged brass stem & collar, for extending existing handle 1-1/2"

MODEL	FITS
EH-1	1/2" & 3/4" BB,MB,SB,SV, 1" model SV
EH-2	1" & 1-1/4" BB,MB,SB, 1-1/4" & 1-1/2" SV
EH-3	1-1/2" & 2" BB,MB,SB, 2" SV

EK-EXTENSION KIT

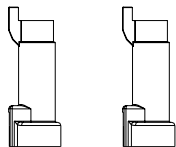

Extension Kit for 2-way Coil Pacs consisting of (2) handle extensions, (3) PTE extenders, & (1) AE accessory extension

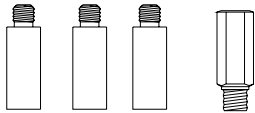

MODEL	FITS
EK-1	All 1/2" & 3/4" 2-way Coil Pacs
EK-1.5	1" 2-way Coil Pacs w/ strainer
EK-2	1" 2-way Coil Pacs w/o strainer, All 1-1/4" 2-way Coil Pacs
EK-2.5	1-1/2" Coil Pacs w/ strainer
EK-3	1-1/2" Coil Pacs w/o strainer, All 2" Coil Pacs

HT-HANGING TAG

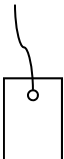

Hanging Tag, plastic with chain for valve identification

Flo-Pac, LLC.
10545 Guilford Road, Unit 103
Jessup, Maryland 20794
www.flo-pacllc.com